

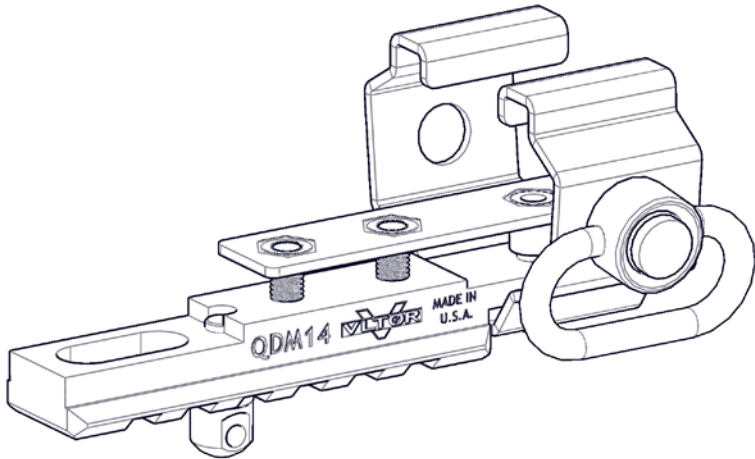

VLTOR WEAPON SYSTEMS

QDM14 M14/M1A Multi-Mount



STOP
READ
THIS!

Improper installation can result in damage. Do not attempt installation if you are not familiar with the firearm, tools and techniques mentioned. You are responsible for any damage or injury resulting from the improper use or installation of this product.

1. Slide mounting bracket over stock forend.

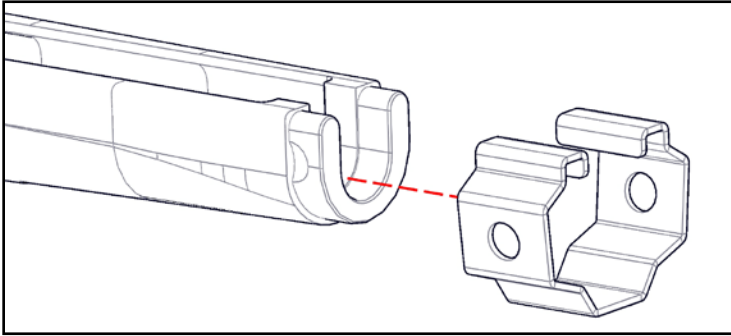

3

2. Slide rail into position.

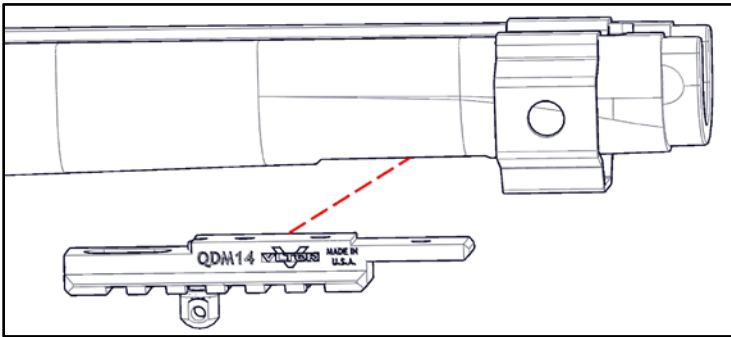

Installation note:

If you have a G.I. stock, use step 3.

If your stock has threaded inserts, skip to step 4.

3. Install two mounting bolts through rail and thread into back plate.

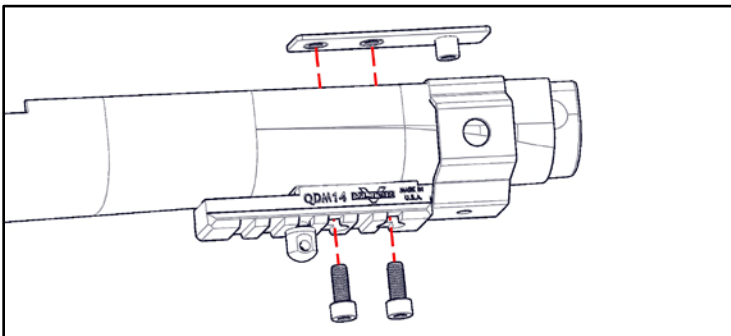

4. Install two mounting bolts through rail and thread into forend.

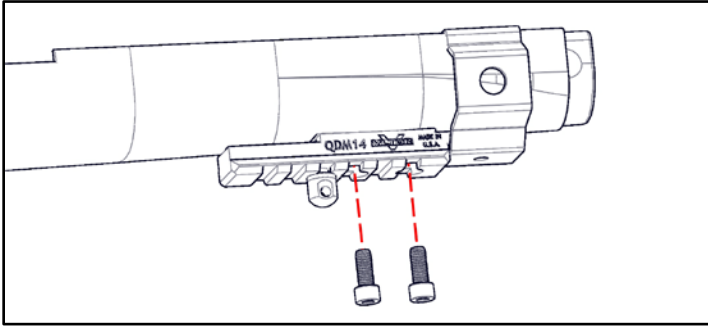

5. Install spacer between bracket and rail then install button-head screw.

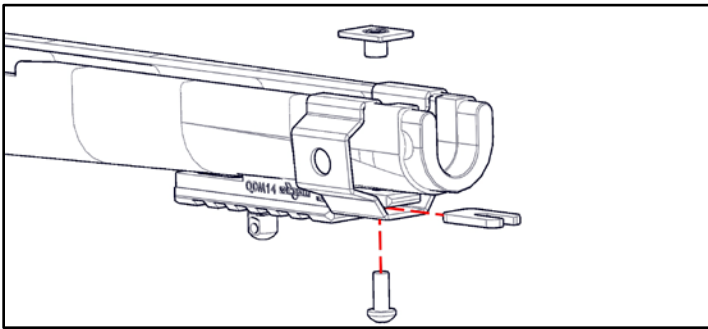

Installation Note:

Short Back Plate is only necessary for stocks with threaded inserts.

Features - A QD Sling Swivel (QDS) may be installed on either side of bracket while a bipod may be installed on lower picatinny rail or traditional sling stud.

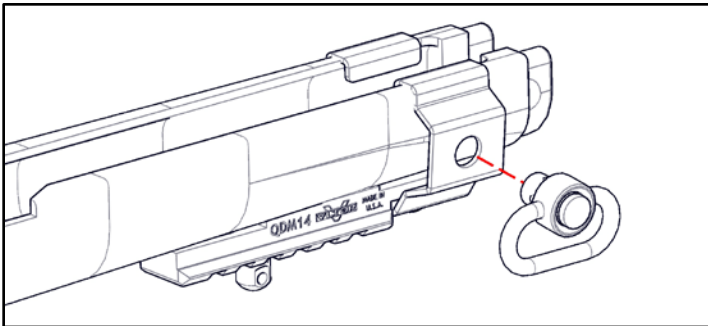

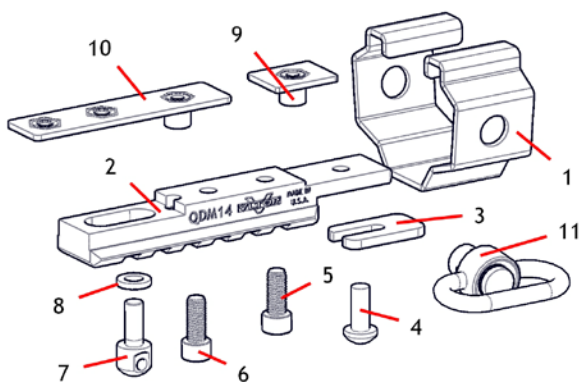

- 1 - Forend Bracket
- 2 - Lower Rail
- 3 - Shim
- 4 - Shim Bolt
- 5 - Rail Bolt
- 6 - Rail Bolt
- 7 - Sling Stud
- 8 - Flange Washer
- 9 - Back Plate (Short)
- 10 - Back Plate (Long)
- 11 - QD Sling Swivel

Vltor Weapon Systems

www.vltor.com - support@vltor.com

(520) 408-1944 Fax (520) 293-8807

Thank you for choosing Vltor!

Copyright 2007 - Vltor Weapon Systems, all rights are reserved.

VISIT OUR ONLINE STORE NOW

WWW.VLTORSTORE.COM